



**PRICE GUIDE:** \$525 per week

## Stunning Townhouse - Stroll to Picnic Point

3 bedroom townhouse in the highly desired Picnic Point precinct.

Quiet and modern living in Maroochydore. The layout of this townhouse is perfect with the ground floor consisting of a spacious, open plan living & kitchen area that interacts perfectly with the private courtyard- a great undercover dining & entertaining option! Single car garaging, laundry and powder room complete this level nicely.

Upstairs has 3 generous bedrooms, all with robes and ceiling fans and a really well laid out bathroom that has a bathtub, separate shower and vanity. There's air conditioning as well for all year comfort.

The quiet location is such a simple stroll to the park, boat ramp and river, as well as being so close to the Sunshine Plaza for all of your shopping needs!

This property is available on a 12 month lease starting Oct 28th, 2021.



**Rental Department**

Gorman & Gray

**OFFICE**



FIRST FLOOR

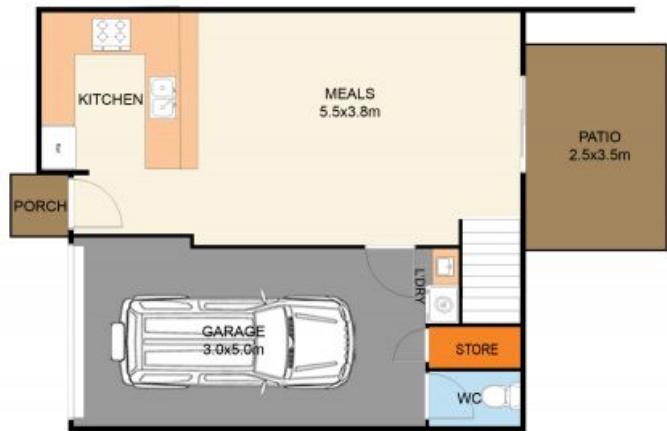

GROUND FLOOR

9/40 Anzac Ave

MAROOCHYDORE