



PRICE GUIDE: \$2 Million Buyer's

Area: 902 m2

Designer Style on Mooloolah Island

The sophisticated Retisma design of this classic Mooloolah Island residence offers a stylish lifestyle focused on low maintenance in/outdoor living. Impeccably finished throughout and displaying a sleek modern layout, it provides a high quality home with excellent natural light and privacy. The outlook is of wide water surrounds and without a return gaze from any neighbours. It is quietly positioned in what is widely regarded as Minyama's finest leafy street and is within a stroll to parks, local shops and school transport.

Experience more of this home, watch the video

- An easy level flow from the interiors to the outdoor space
- Light filled open plan design with formal and casual areas
- Landscaped rear deck and entertainment area
- Generous 3 car auto garage with large storage room/workshop
- Chic modern kitchen and quality appliances



Anthony Gorman
0417587758

Gorman & Gray

OFFICE



GROUND FLOOR

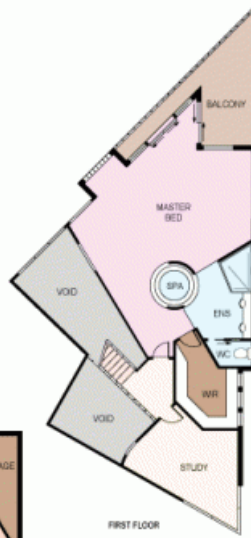

FIRST FLOOR

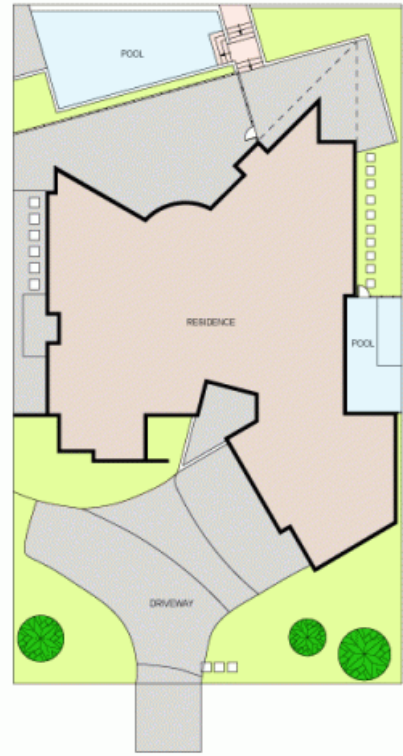

SITE PLAN
(NOT TO SCALE)

0 2 4 6 8 10 METERS